

Roper Reserve  
**PAXTON**



**Elevation A**

**Approx. square feet:** 4,300

**Stories:** 2

**Bedrooms:** 6

**Garage:** 3-car

**Plan Number:** F43P

The main floor inviting Paxton plan provides ample entertaining options, including a formal dining room with a butler's pantry, an open great room with an optional fireplace and a well-appointed kitchen with an island, nook and adjacent patio. You'll also appreciate a quiet study, full bath, convenient bedroom and 3-car garage. Upstairs, discover a laundry, a large loft and five additional bedrooms, including a luxurious master suite with a private retreat and oversized walk-in closet. A gourmet kitchen, covered patio and dual master baths are available.

**Available elevations:**



**Elevation A**



**Elevation B**



**Elevation C - Shown with optional stone**



**Elevation D**



**Elevation E**



**Elevation F**

**COMMUNITY LOCATION**

412 Silver Dollar Lane  
Winter Garden, FL 34787  
321-441-3671

**HOME GALLERY**

2822 Commerce Park Drive, Suite 100  
Orlando, FL 32819  
407-450-7309



**COMMUNITY LOCATION**

412 Silver Dollar Lane  
Winter Garden, FL 34787  
321-441-3671

**HOME GALLERY**

2822 Commerce Park Drive, Suite 100  
Orlando, FL 32819  
407-450-7309



Roper Reserve  
**PAXTON**

Approx. square feet: 4,300  
Stories: 2  
Bedrooms: 6

Garage: 3-car  
Plan Number: F43P

**Floor Plan**  
Main Floor

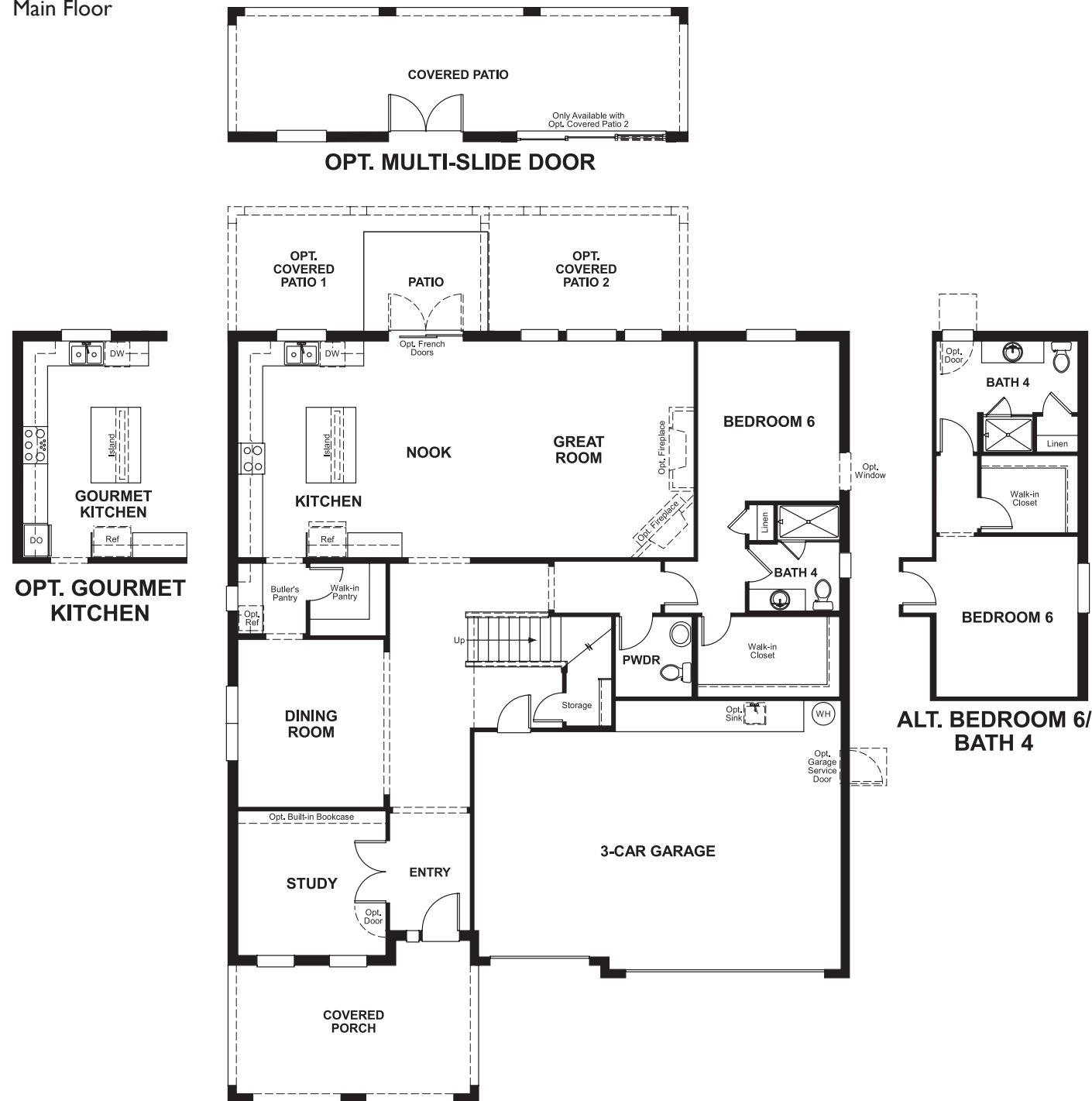

**Floor Plan**  
Second Floor



**THIS PLAN'S PROJECTED  
HERS® INDEX = 61** \*  
Projected Rating Based on Plans – Field Confirmation Required

**How does this floor plan rate?**  
Take a look: **100** = Standard new home\* **130** = Typical resale home\*\*  
The lower the number, the better! Refer to the RESNET® HERS index brochure or go to [www.RESNET.us](http://www.RESNET.us) for details.

**What's a HERS® Index?** HERS stands for Home Energy Rating System, a system created by RESNET® to measure home energy efficiency.<sup>^</sup>  
A Projected HERS index or rating is a computer simulation performed prior to construction by a third-party HERS rater using RESNET-accredited rating software, rated feature and specification data derived from home plans, features and specifications, and other data selected or assumed by the rater. The projected HERS index is approximate and is subject to change without notice. Actual results will vary.

\*This information is presented for education purposes only. The HERS index for a confirmed rating will be determined by a third-party HERS rater based on data gathered from on-site observations and, if required, testing of rated features for a home as featured, optioned, located, oriented and/or built.  
+Standard new home is based on the RESNET® Reference Home definition with a HERS® index of 100 (based on the 2006 International Energy Conservation Code).  
++Typical resale home is based on the U.S. Department of Energy definition with a HERS® index of 130.

<sup>^</sup>RESNET® has developed the HERS® index to indicate the comparative efficiencies of homes. It is no guarantee that energy efficiencies will be achieved.