

Travis Park - I & II
BEDFORD



Elevation A

Approx. square feet: 2,300
Stories: 2
Bedrooms: 3
Garage: 2-car
Plan Number: P722

The beautiful Bedford plan offers two stories of smartly designed living space. On the main floor, you'll find generous dining and great rooms and a charming corner kitchen with a center island, as well as a convenient mudroom and powder room off the 2-car garage. Upstairs, enjoy a versatile loft, centrally located laundry room, hall bath and three inviting bedrooms—including a lavish master suite with a walk-in closet and private bath. A relaxing covered patio is also included. Personalize this plan with a sunroom, a gourmet kitchen and an extra bedroom in lieu of the loft!

Available elevations:



Elevation A



Elevation B



Elevation C



COMMUNITY LOCATION

372 North 159th Avenue
 Goodyear, AZ 85338
 623-587-9438

HOME GALLERY

16427 North Scottsdale Road, Suite 175
 Scottsdale, AZ 85254
 877-444-1485



COMMUNITY LOCATION

372 North 159th Avenue
 Goodyear, AZ 85338
 623-587-9438

HOME GALLERY

16427 North Scottsdale Road, Suite 175
 Scottsdale, AZ 85254
 877-444-1485

Travis Park - I & II
BEDFORD

Approx. square feet: 2,300
Stories: 2
Bedrooms: 3

Garage: 2-car
Plan Number: P722

Floor Plan
Main Floor

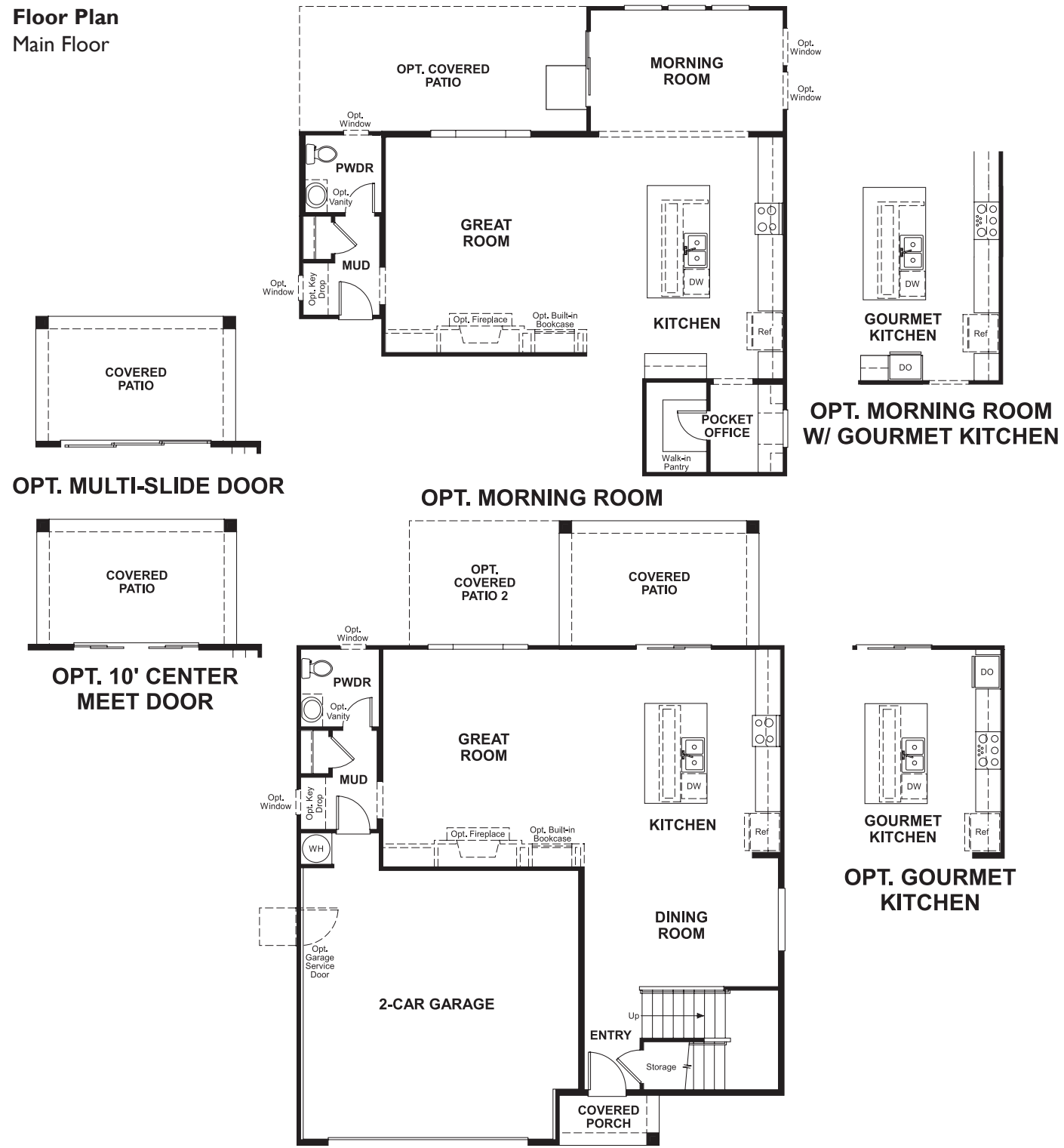

Floor Plan
Second Floor



**THIS PLAN'S PROJECTED
HERS® INDEX = 66***
Projected Rating Based on Plans – Field Confirmation Required

How does this floor plan rate?
Take a look: **100** = Standard new home* **130** = Typical resale home**
The lower the number, the better! Refer to the RESNET® HERS index brochure or go to www.RESNET.us for details.

What's a HERS® Index? HERS stands for Home Energy Rating System, a system created by RESNET® to measure home energy efficiency.[^]
A Projected HERS index or rating is a computer simulation performed prior to construction by a third-party HERS rater using RESNET-accredited rating software, rated feature and specification data derived from home plans, features and specifications, and other data selected or assumed by the rater. The projected HERS index is approximate and is subject to change without notice. Actual results will vary.

*This information is presented for education purposes only. The HERS index for a confirmed rating will be determined by a third-party HERS rater based on data gathered from on-site observations and, if required, testing of rated features for a home as featured, optioned, located, oriented and/or built.
+Standard new home is based on the RESNET® Reference Home definition with a HERS® index of 100 (based on the 2006 International Energy Conservation Code).
++Typical resale home is based on the U.S. Department of Energy definition with a HERS® index of 130.

[^]RESNET® has developed the HERS® index to indicate the comparative efficiencies of homes. It is no guarantee that energy efficiencies will be achieved.