

BRICKYARD WEST

BRICKYARD WEST

BRICKYARD WEST
HANCOCK

APPROX. SQUARE FEET: 1,950
STORIES: 3

BEDROOMS: 3
GARAGE: 2-CAR

BRICKYARD WEST
HANCOCK

FLOOR PLAN LOWER FLOOR

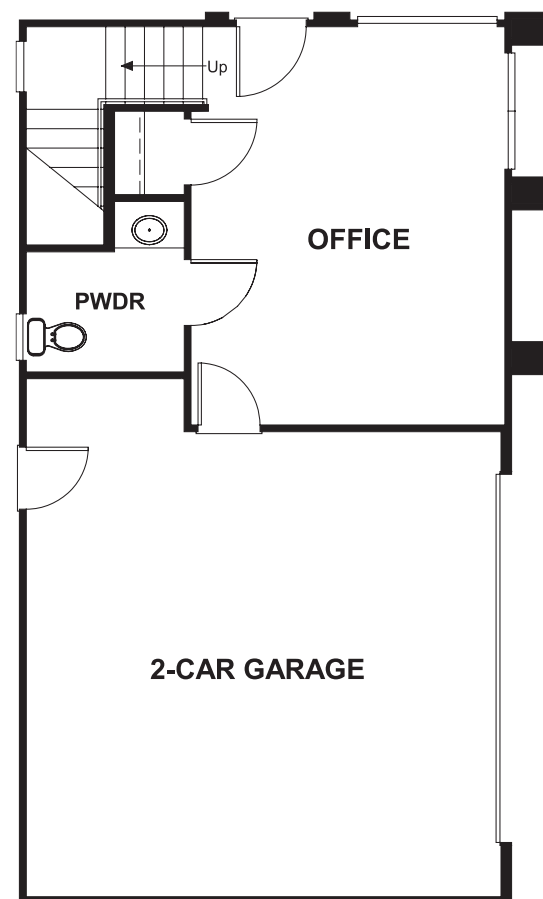

BRICKYARD WEST

CITYSCAPE COLLECTION by Richmond American

APPROX. SQUARE FEET: 1,950
STORIES: 3
BEDROOMS: 3
GARAGE: 2-CAR

The lower floor of the Hancock plan features private, dedicated office space and a convenient powder room. On the main floor, enjoy open living and dining rooms and an impressive kitchen with an immense center island and an adjacent balcony. Upstairs offers a lavish master suite and two additional bedrooms, which can be optioned as a second master suite. The home is crowned with a relaxing rooftop terrace.



COMMUNITY LOCATION
2026 Placentia Avenue
Costa Mesa, CA 92627
800-852-9714

HOME GALLERY
5171 California Avenue, Suite 110
Irvine, CA 92617
800-852-9714



COMMUNITY LOCATION
2026 Placentia Avenue
Costa Mesa, CA 92627
800-852-9714

HOME GALLERY
5171 California Avenue, Suite 110
Irvine, CA 92617
800-852-9714



RICHMONDAMERICAN.COM/BRICKWEST

Floorplans and renderings are conceptual drawings and may vary from actual plans and homes as built. Options and features may not be available on all homes and are subject to change without notice. Actual homes may vary from photos and/or drawings which show upgraded landscaping and may not represent the lowest-priced homes in the community. Features may include optional upgrades and may not be available on all homes. Square footage numbers are approximate and are subject to change without notice. Prices, specifications and availability subject to change without notice. ©2015 Richmond American Homes, Richmond American Homes of Maryland, Inc. California Department of Real Estate - Real Estate Broker, Corporation License Number 01842595. 9/22/2015

Floorplans and renderings are conceptual drawings and may vary from actual plans and homes as built. Options and features may not be available on all homes and are subject to change without notice. Actual homes may vary from photos and/or drawings which show upgraded landscaping and may not represent the lowest-priced homes in the community. Features may include optional upgrades and may not be available on all homes. Square footage numbers are approximate and are subject to change without notice. Prices, specifications and availability subject to change without notice. ©2015 Richmond American Homes, Richmond American Homes of Maryland, Inc. California Department of Real Estate - Real Estate Broker, Corporation License Number 01842595. 9/22/2015

FLOOR PLAN MAIN FLOOR



FLOOR PLAN UPPER FLOOR

