

BASEMENT

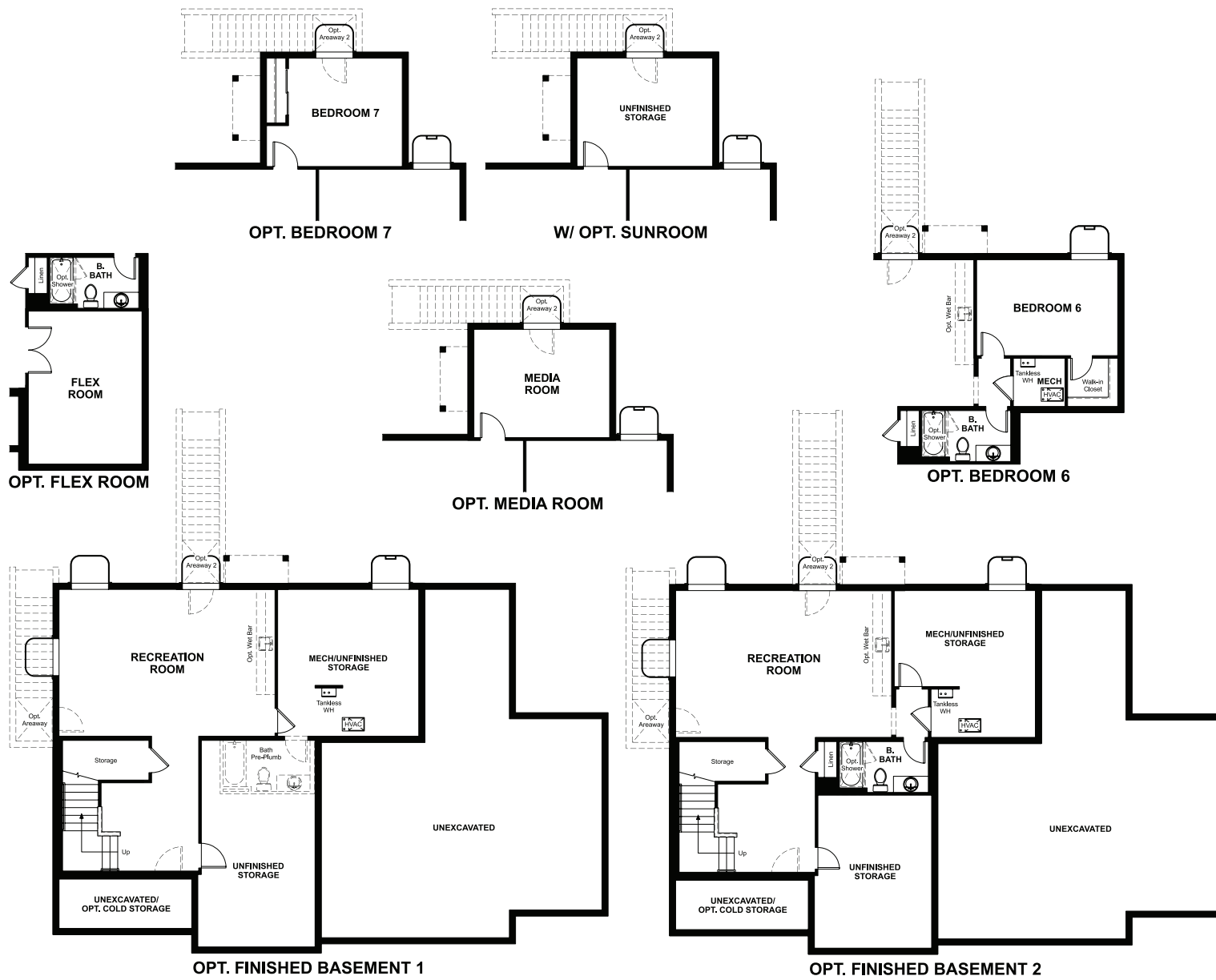

ELEVATION D

ABOUT THE PRESLEY

The eye-catching Presley plan was designed for entertaining, boasting a covered front porch, an open great room and an inviting kitchen with optional gourmet features. You'll also appreciate a mudroom, a powder room, a study and a 3-car garage with a shop. Upstairs, enjoy a convenient laundry, a versatile loft and two generous bedrooms with walk-in closets and a shared bath. There is also a lavish owner's suite featuring an immense walk-in closet and private bath with three deluxe options. Additional options include a sunroom, extra bedroom, covered patio, finished basement.



ELEVATION A



ELEVATION B



ELEVATION C

COMMUNITY LOCATION:

Jones Court | 1785 South 100 E. | Orem, UT 84058 | 801.545.3429

DESIGN CENTER LOCATION:

Utah Home Gallery™ | 849 W. LeVoy Drive, Suite 108 | Salt Lake City, UT 84123 | 801.545.5167



Floor plans and renderings are conceptual drawings and may vary from actual plans and homes as built. Actual homes may vary from photos and/or drawings, which show upgraded landscaping and may not represent the lowest-priced homes in the community. Options and features may not be available on all homes and are subject to change without notice. Square footage and plan dimensions are approximate and may show approximate total available footage with finished and unfinished footages listed separately. Unfinished areas may be available to be finished. Finished basement areas below grade may vary in value from finished above-grade areas. Prices, specifications and availability are subject to change without notice. ©2022 Richmond American Homes, Richmond American Homes of Utah, Inc. (866.400.4131). 06/28/2022

MAIN FLOOR

SECOND FLOOR

