

Silver Creek  
**DALLAS**



**Elevation A**

**Available elevations:**



**Elevation A**



**Elevation B**



**Elevation C**

**Approx. square feet:** 2,900  
**Stories:** 2  
**Bedrooms:** 3 - 5  
**Garage:** 3-car  
**Plan Number:** L599

Front- and side-entry garages and a covered front porch lend to the charm of the inspired Dallas plan. Inside, you'll find a formal dining room, an open great room with optional fireplace and a quiet study that can be converted to an extra bedroom. The gourmet kitchen boasts a walk-in pantry, a center island with breakfast bar and a generous nook. Upstairs, discover a laundry, a loft that can be optioned as an additional bedroom and an elegant master suite with a deluxe master bath.

**COMMUNITY LOCATION**

Durango Drive and Ford Avenue  
Las Vegas, NV 89113  
702-638-4440

**HOME GALLERY**

7770 South Dean Martin Drive, Suite 308  
Las Vegas, NV 89139  
702-617-8400



**COMMUNITY LOCATION**

Durango Drive and Ford Avenue  
Las Vegas, NV 89113  
702-638-4440

**HOME GALLERY**

7770 South Dean Martin Drive, Suite 308  
Las Vegas, NV 89139  
702-617-8400



**Floor Plan**  
Main Floor

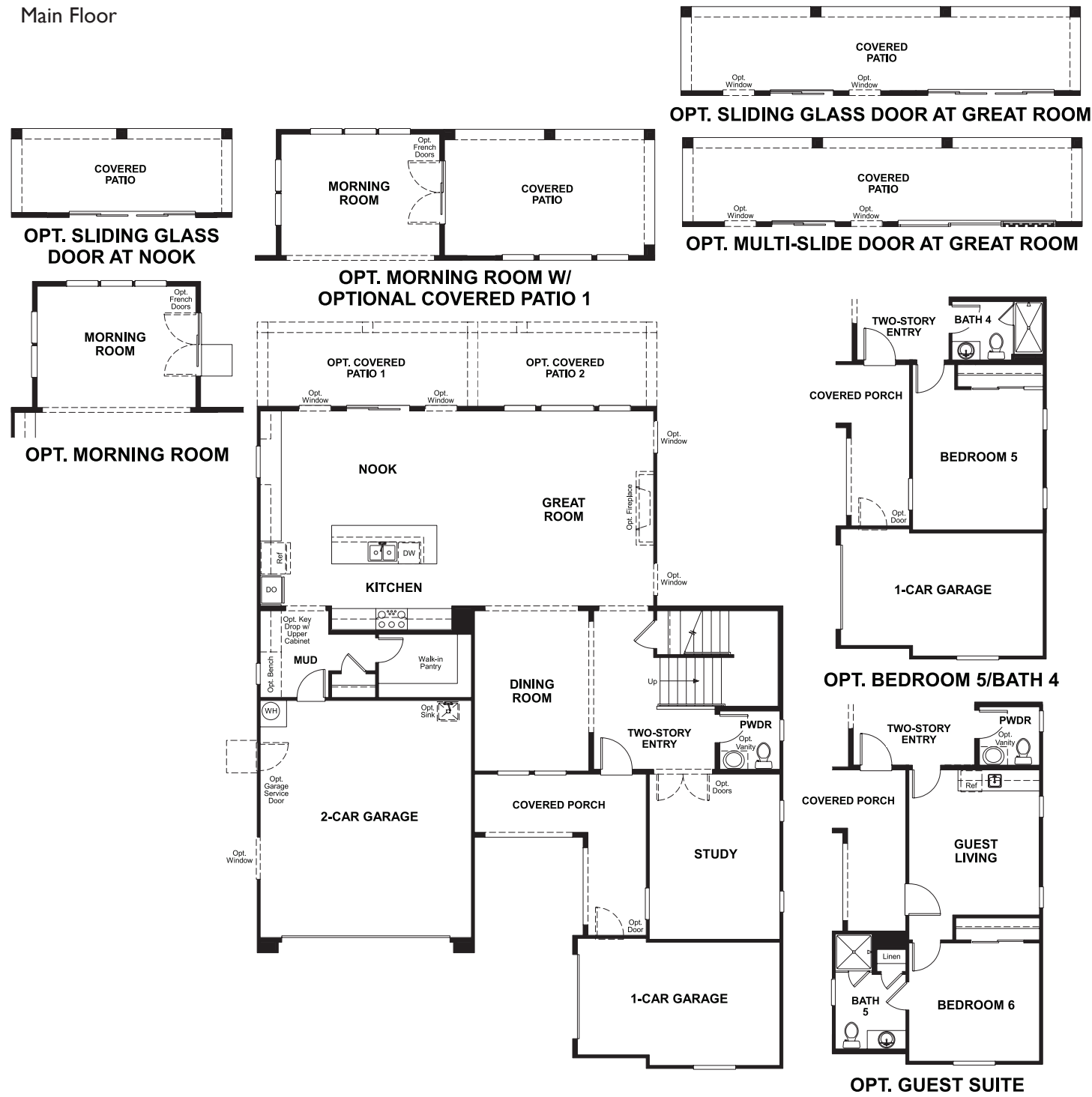

**Floor Plan**  
Second Floor

