

The Summit at San Elijo  
**REILLY**



**Elevation A**

**Available elevations:**



**Elevation A**



**Elevation B**



**Elevation D**

**Approx. square feet:** 4,200

**Stories:** 2

**Bedrooms:** 4 - 5

**Garage:** 3-car

**Plan Number:** S692

The main floor of the Riley plan is ideal for entertaining, with an opening dining room, a generous great room and a gourmet kitchen, complete with center island and walk-in pantry. You'll also appreciate three inviting bedrooms, including an elegant master suite with dual closets and a deluxe bath, and a relaxing covered patio. Upstairs, enjoy a versatile bonus room with a covered deck and a guest suite with a full bath and living area. Personalize this plan with a tech center, professional kitchen and more!

**COMMUNITY LOCATION**

526 Ledge Street  
San Marcos, CA 92078  
760-653-7010

**HOME GALLERY**

5171 California Avenue  
Irvine, CA 92617  
800-852-9714



**COMMUNITY LOCATION**

526 Ledge Street  
San Marcos, CA 92078  
760-653-7010

**HOME GALLERY**

5171 California Avenue  
Irvine, CA 92617  
800-852-9714



The Summit at San Elijo  
**REILLY**

**Approx. square feet: 4,200**  
**Stories: 2**  
**Bedrooms: 4 - 5**

**Garage: 3-car**  
**Plan Number: S692**

**Floor Plan**  
Main Floor

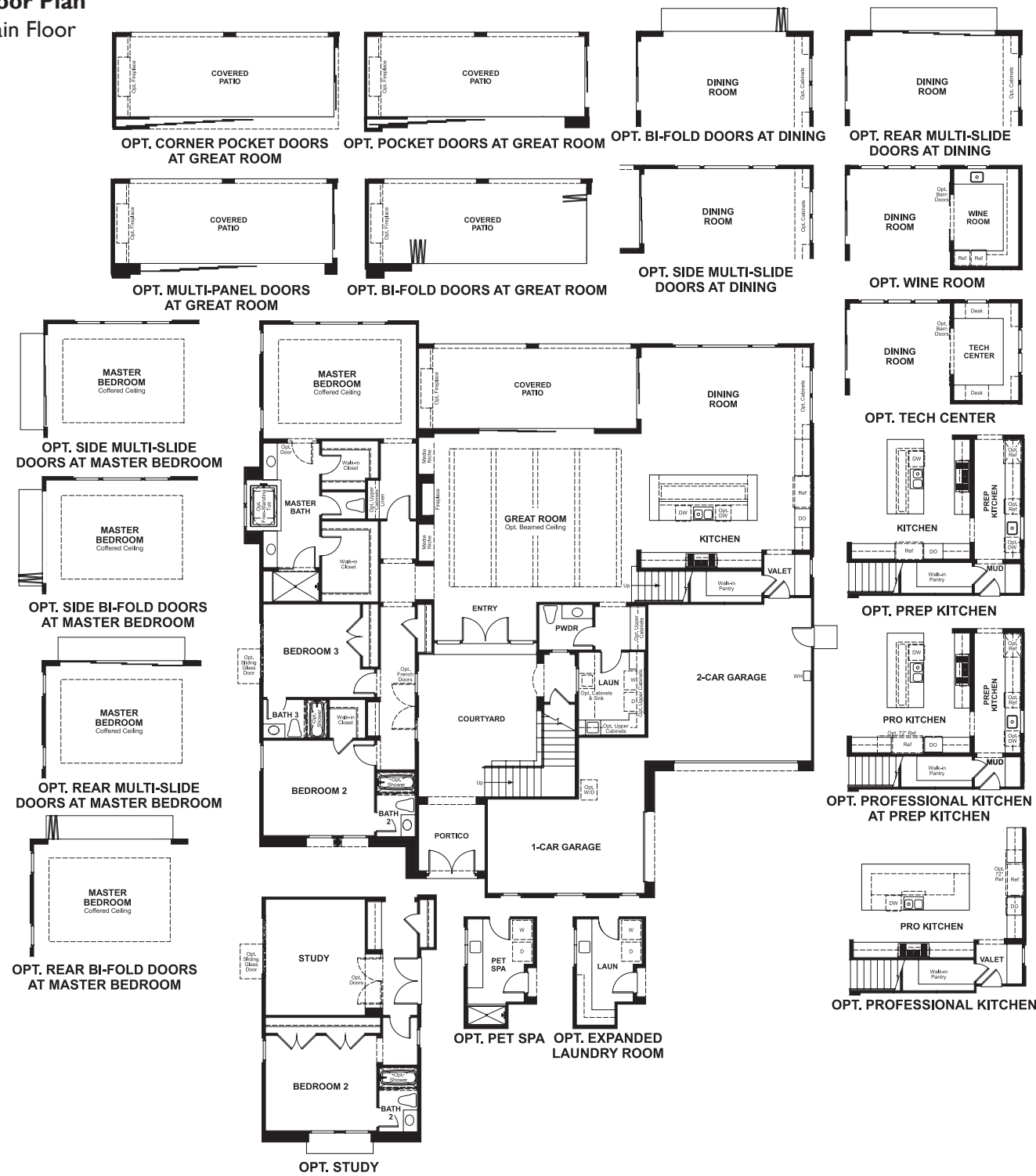

**Floor Plan**  
Second Floor

