

Old Dominion Greens  
**VANDERBILT II**

**Approx. square feet:** 3,200  
**Stories:** 2  
**Bedrooms:** 5

**Garage:** 2-car  
**Plan Number:** M321

**Floor Plan**  
Basement

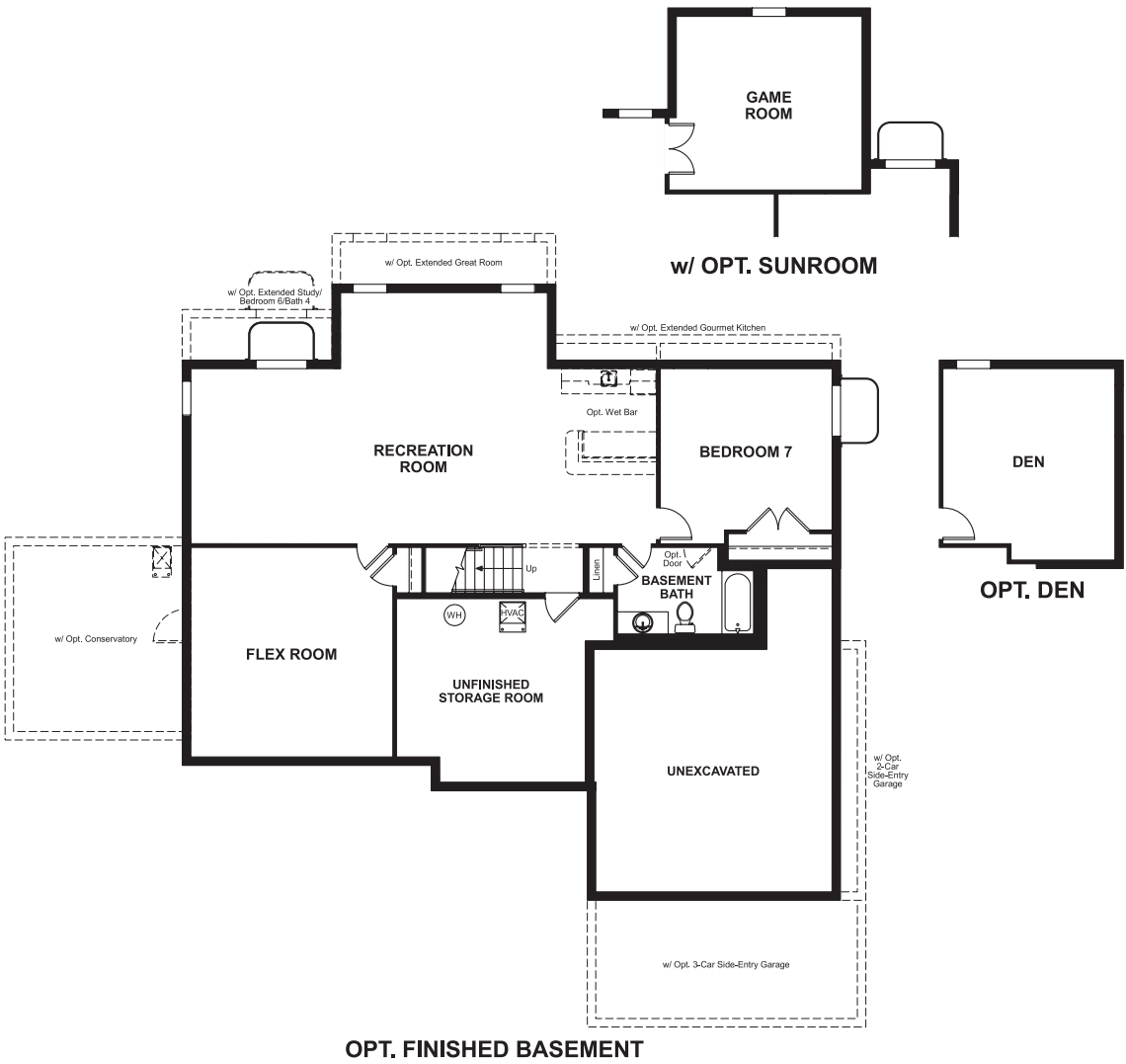

**Elevation A**

**Available elevations:**



**Elevation A**



**Elevation B**



**Elevation C**



**Elevation D**

**COMMUNITY LOCATION**  
218 Bridgewater Drive  
Stephens City, VA 22655  
540-548-4435

**HOME GALLERY**  
11393 Government Center Parkway  
Fairfax, VA 22030  
888-891-7349



**COMMUNITY LOCATION**  
218 Bridgewater Drive  
Stephens City, VA 22655  
540-548-4435

**HOME GALLERY**  
11393 Government Center Parkway  
Fairfax, VA 22030  
888-891-7349



**OPT. 3-CAR SIDE ENTRY GARAGE**

**OPT. FIREPLACE**

**OPT. COFFEE BAR**

The diagram shows two alternative layouts for the kitchen area. The top option, labeled 'OPT. FIREPLACE', shows a fireplace unit with a chimney pipe extending upwards, indicated by an arrow and the word 'Up'. The bottom option, labeled 'OPT. COFFEE BAR', shows a coffee bar unit with a built-in coffee machine, a walk-in closet, and a linen closet.