

Sunset Terrace
RYDER



Elevation A

Available elevations:



Elevation B



Elevation C

Approx. square feet: 3,790

Stories: 1

Bedrooms: 4

Garage: 3-car

Plan Number: P38R

The Ryder offers a smartly designed layout packed with personalization options. Love outdoor living? Add a courtyard entry. Are you a top chef? Opt for a professional kitchen package. Looking for the ultimate spa experience? Select a free-standing tub or expansive walk-in shower for the master bath. You'll also appreciate a large covered patio—accessible from the great room and breakfast nook—a formal dining room, a secluded study and a versatile game room with an optional fireplace. Also includes two garages!



COMMUNITY LOCATION

13770 West Bloomington Street
Litchfield Park, AZ 85340
480-624-0244

HOME GALLERY

16427 North Scottsdale Road, Suite 175
Scottsdale, AZ 85254
877-444-1485



COMMUNITY LOCATION

13770 West Bloomington Street
Litchfield Park, AZ 85340
480-624-0244

HOME GALLERY

16427 North Scottsdale Road, Suite 175
Scottsdale, AZ 85254
877-444-1485

Sunset Terrace
RYDER

Approx. square feet: 3,790
Stories: 1
Bedrooms: 4

Garage: 3-car
Plan Number: P38R

Floor Plan
Main Floor

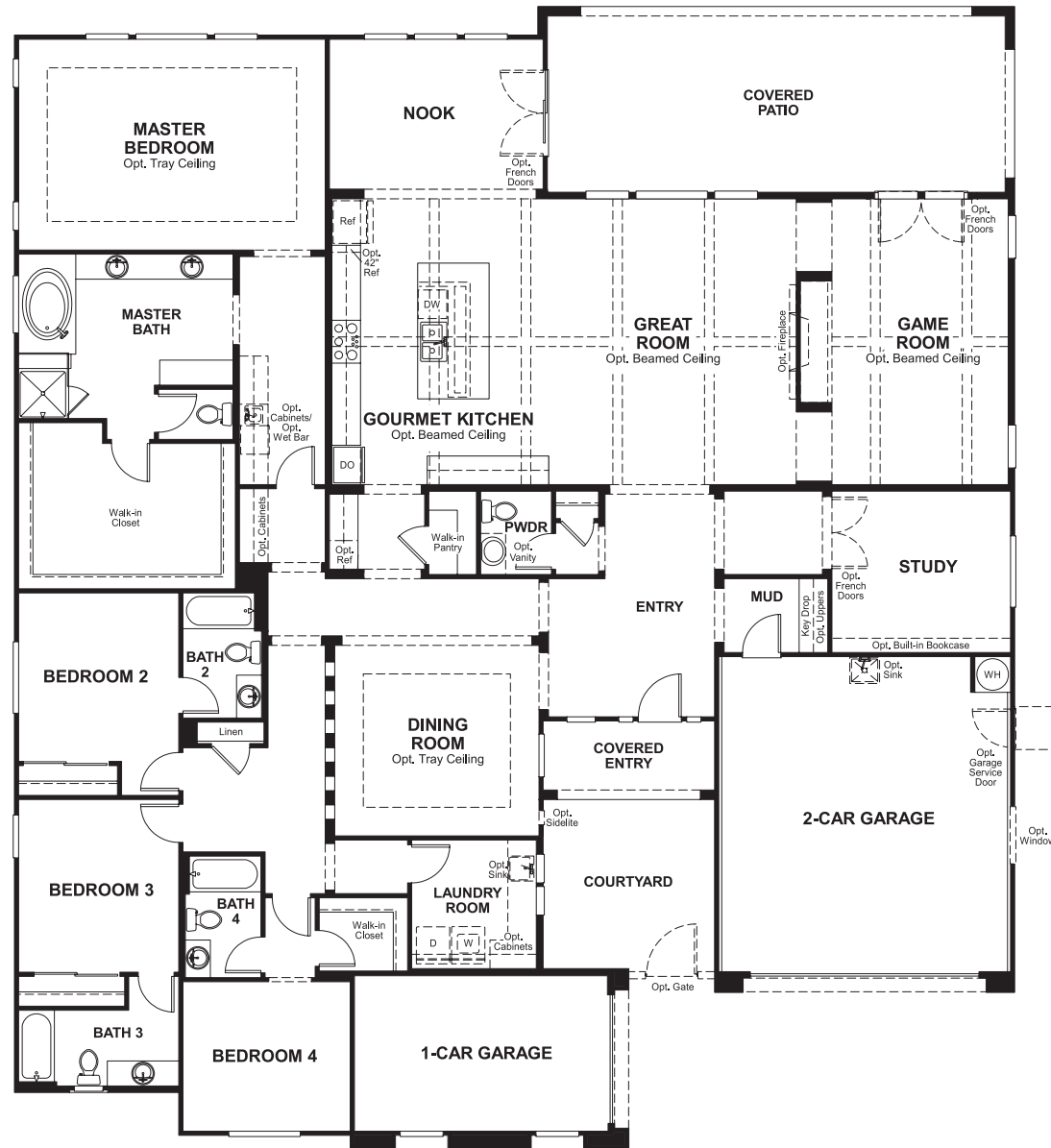

Floor Plan
Main Floor Options

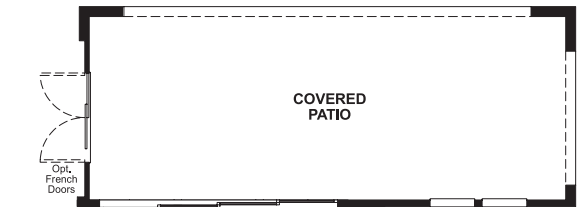

OPT. MULTI-SLIDE DOOR AT GREAT ROOM

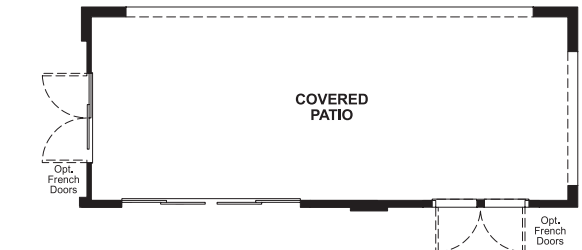

OPT. 12' CENTER-MEET DOOR AT GREAT ROOM

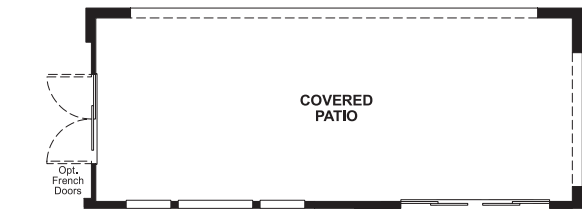

OPT. 10' CENTER-MEET DOOR AT GAME ROOM

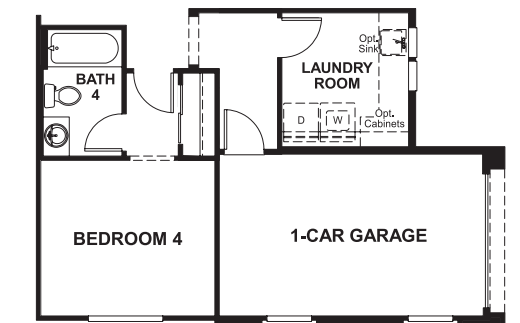

OPT. ALTERNATE GARAGE ENTRANCE

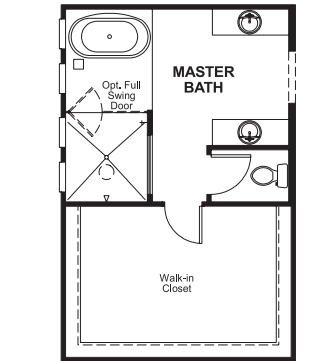

OPT. WALK-IN SHOWER W/ FREE-STANDING TUB

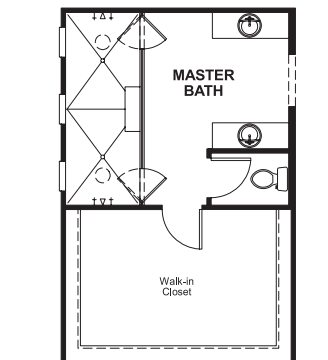

OPT. WALK-IN SHOWER

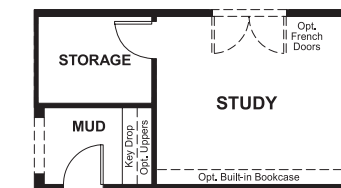

OPT. ALTERNATE STUDY ENTRANCE

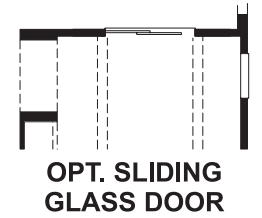

OPT. SLIDING GLASS DOOR

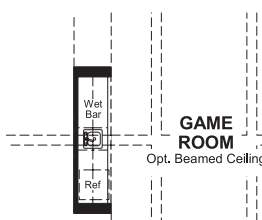

OPT. WET BAR

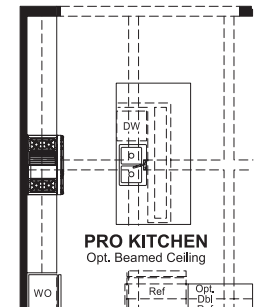

OPT. PROFESSIONAL KITCHEN

THIS PLAN'S PROJECTED HERS® INDEX = 59*
Projected Rating Based on Plans – Field Confirmation Required

How does this floor plan rate?
Take a look: 100 = Standard new home* 130 = Typical resale home**
The lower the number, the better! Refer to the RESNET® HERS index brochure or go to www.RESNET.us for details.

What's a HERS® Index? HERS stands for Home Energy Rating System, a system created by RESNET® to measure home energy efficiency.[^]
A Projected HERS index or rating is a computer simulation performed prior to construction by a third-party HERS rater using RESNET-accredited rating software, rated feature and specification data derived from home plans, features and specifications, and other data selected or assumed by the rater. The projected HERS index is approximate and is subject to change without notice. Actual results will vary.

*This information is presented for education purposes only. The HERS index for a confirmed rating will be determined by a third-party HERS rater based on data gathered from on-site observations and, if required, testing of rated features for a home as featured, optioned, located, oriented and/or built.
+Standard new home is based on the RESNET® Reference Home definition with a HERS® index of 100 (based on the 2006 International Energy Conservation Code).
++Typical resale home is based on the U.S. Department of Energy definition with a HERS® index of 130.

[^]RESNET® has developed the HERS® index to indicate the comparative efficiencies of homes. It is no guarantee that energy efficiencies will be achieved.