

THE DEVOE

Approx. 1,930 sq. ft. | 2 to 3 bed | 2.5 bath | 2-car garage | Plan #D578

LOWER FLOOR

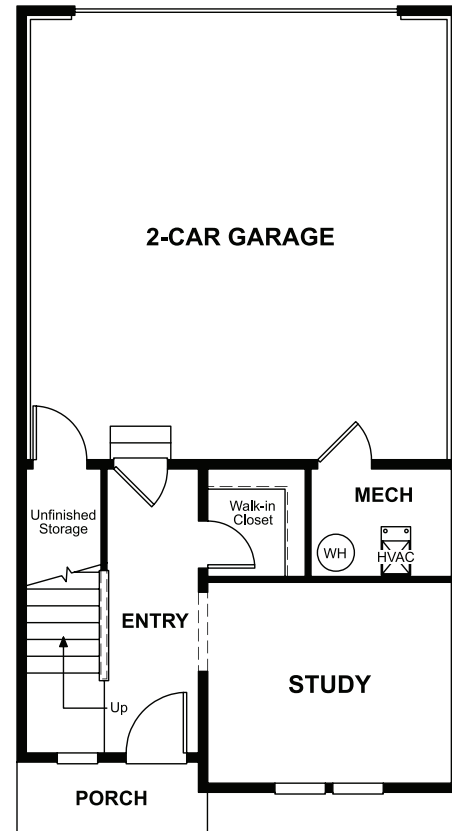

ELEVATION F

ABOUT THE DEVOE

The new Devoe plan is as innovative as it is stylish. Its open, inviting main floor includes a spacious kitchen with optional gourmet features, an adjacent dining area and an inviting living room with a private deck. Upstairs, you'll find relaxing owner's suite with an optional deluxe bath. The rooftop terrace on the 4th floor is ideal for entertaining guests.

COMMUNITY LOCATION:

Cityscape at Haskins Station | 5315 B Queen Court | Arvada, CO 80002 | 303.694.4788

DESIGN CENTER LOCATION:

Denver Metro Home Gallery™ | 9300 E. Belleview Avenue, Suite C-12 | Greenwood Village, CO 80111 | 888.402.4663



ELEVATION C



ELEVATION D



ELEVATION E



Floor plans and renderings are conceptual drawings and may vary from actual plans and homes as built. Options and features may not be available on all homes and are subject to change without notice. Actual homes may vary from photos and/or drawings which show upgraded landscaping and may not represent the lowest-priced homes in the community. Features may include optional upgrades and may not be available on all homes. Prices, specifications and availability are subject to change without notice. Square footage is approximate and subject to change without notice. ©2022 Richmond American Homes, Richmond American Homes of Colorado, Inc. 2/22/2022

MAIN FLOOR

UPPER FLOOR

