

THE HARRIS

Approx. 2,450 sq. ft. | 3 to 5 bed | 2 to 3 bath | 2-car + RV garage | Plan #D23H

BASEMENT

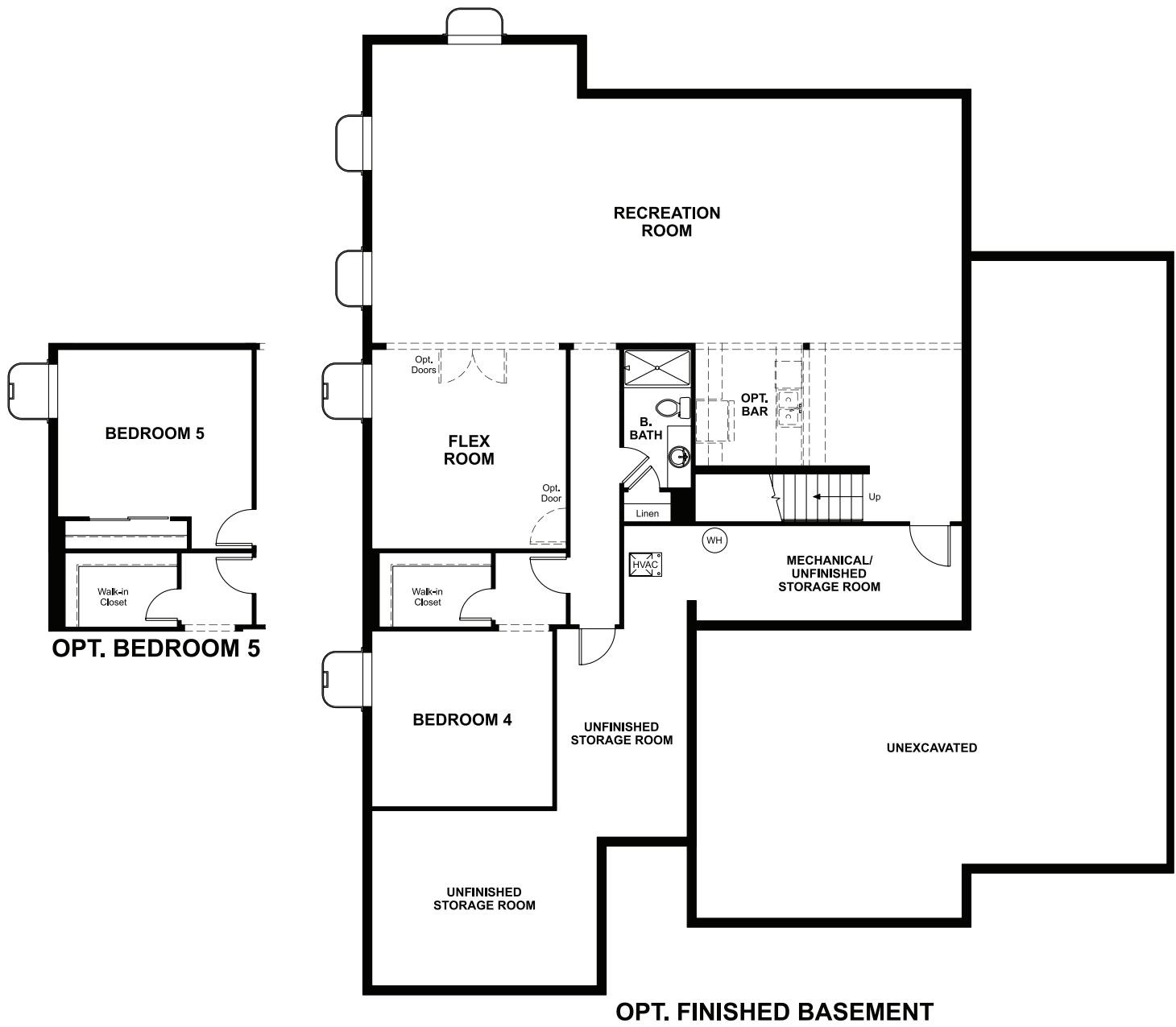

ELEVATION E

ABOUT THE HARRIS

Designed for entertaining, the ranch-style Harris plan offers a formal dining room, an open great room and a well-appointed kitchen with a spacious center island. Three generous bedrooms, including an elegant owner's suite with attached bath, provide ample space for rest and relaxation. A convenient laundry, 2-car garage and RV garage are also included. Personalize this plan with a private study in lieu of the dining room, gourmet or professional kitchen features and a finished basement!

COMMUNITY LOCATION:

The Pinnacle at Cobblestone Ranch | 6289 Leilani Drive | Castle Rock, CO 80108 | **303.651.0489**

DESIGN CENTER LOCATION:

Denver Metro Home Gallery™ | 8000 E. Belview Avenue, Suite C-12 | Greenwood Village, CO 80111 | **888.402.4663**



Floor plans and renderings are conceptual drawings and may vary from actual plans and homes as built. Options and features may not be available on all homes and are subject to change without notice. Actual homes may vary from photos and/or drawings which show upgraded landscaping and may not represent the lowest-priced homes in the community. Features may include optional upgrades and may not be available on all homes. Prices, specifications and availability are subject to change without notice. Square footage is approximate and subject to change without notice. ©2021 Richmond American Homes, Richmond American Homes of Colorado, Inc. 8/26/2021



ELEVATION A



ELEVATION C



ELEVATION D

MAIN FLOOR

MAIN-FLOOR OPTIONS

